

Epoxy Putty

RECTOR SEAL

All-purpose putty

TEMP. -40~200°C

Tough & Durable !

Harden like a metal in 15~20min after kneading.

Just cut and knead it

Easy to use putty type everywhere

DRINKING WATER LINE OK

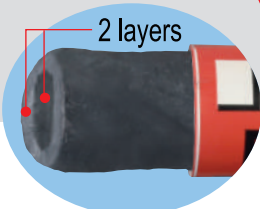
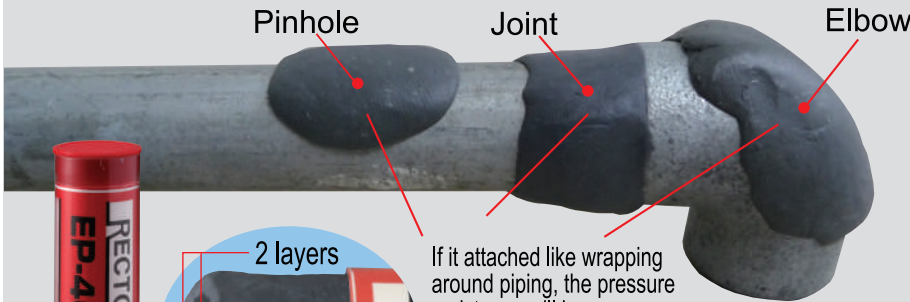

If it attached like wrapping around piping, the pressure resistance will increase.

This product has layers of two components, combining by kneading and hardening.

Joint



EP-400

EP-200

EP-200W



EP-200 (24pcs)



EP-400 (12pcs)



The use is diverse, such as repairing holes and cracks, reforming the surface.

- ◆ Piping (Stainless, Copper, Steel, PVC)
- ◆ Air conditioner (Duct, Unit, Fan)
- ◆ Electrical machinery (Housing motor, Shaft)
- ◆ Industry (Equipment, Pump casing)
- ◆ Car (Oil tank, Engine block, Fan, Muffler, Oil pan, Radiator)
- ◆ Shipping (Hull, Piping, Pump casing)
- ◆ Agriculture (Tools, Machinery)
- ◆ DIY (Tile, Wall, Piping, Cabinet, Door)

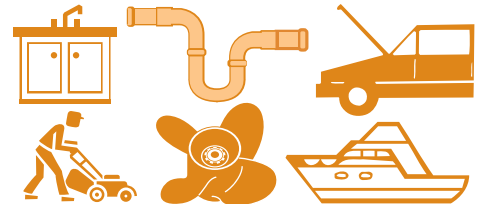

RECTOR SEAL

	EP-200	EP-200W	EP-400
Contents	56g	56g	112g
Color	Gray	White	Gray
Material	Epoxy resin		
Hardness	Shore D85		
Temperature	-40~200°C		
Pressure	10kg/cm ²		
Tensile strength	420kg/cm ²		
Compressive strength	1,260kg/cm ²		
Elastic coefficient	6×10 ³ PSI		
Shear strength	49kg/cm ²		
Insulation properties	400Volts/mil 0.125in		
Volume resistance	5×10 ¹⁵ Ω·cm		
JAN code	4560361000010	4560361000034	4560361000041

◆ Chemical resistance	
○=Conformity ×=Non-conformity	
10%Acetic acid	○
2%Nitric acid	○
10%Sulfuric acid	○
10%Hydracid	○
Acetone	○
Xylole	○
Gasoline	○
Methanol	○
Ethanol	○
10%Hydrochloric acid	○
Caustic soda	○

Approval of Food Sanitation Act No.370/20

<How to use>※ Please repair under non-pressure.

※ First of all, please remove dirt, paint, dust, rust, oil etc. on the adhesion surface.

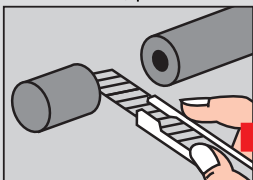

① Remove the packaging film and cut it in the required amount.

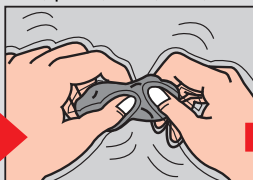

② Knead it for 1~2mins until there is no color unevenness.

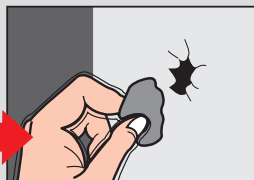

③ Embed and mold so as to press against the adhesive / filling spot.

- ※ If you use a wet cloth or wet spatula, it will be beautiful finished.
- ※ When the temperature is low, the time to complete hardening becomes longer. Please use at temperature above 5°C.
- ※ Please be careful as excessive kneading and redoing of molding after adhesion will cause poor adhesion and poor hardening.
- ※ Recommend to combine with Quick Tape and Arlon Tape for piping repair.

- Cover Rector Seal by Quick Tape for additional strength.
- Cover Arlon Tape by Rector Seal for protection.

④ Harden and adhere in 15~20mins. It can be done tapping, buffing, painting and etc. after completed hardening (1 hour)